

Targus®

**POWER
INVERTER
AUTO/AIR
100W**

User Guide

Model: APV10US1

Targus Power Inverter Auto/Air 100W

Power / Fault Indicator

This light will flash (blue color) if the inverter encounters problems.

LED is ON – Normal operation.

LED is flashing – Low voltage warning signal indicates the supply voltage is low.

LED is OFF – Unit is off and no power is being output. Either the inverter is not plugged into a powered socket or it has gone into protection mode due to overheating, overvoltage, overloading or short circuit.

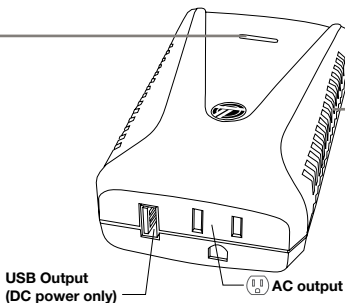

Ventilation openings

WARNING

- Do not block or cover any louvered vents . Place the inverter on a flat surface with good ventilation between 0-35 °C and ideally 15-25 °C.
- Do not place the inverter on or near a heating vent or any piece of heat generating equipment. Keep inverter away from direct sunlight, if at all possible.
- Do not allow water or other liquids to come into contact with the inverter.

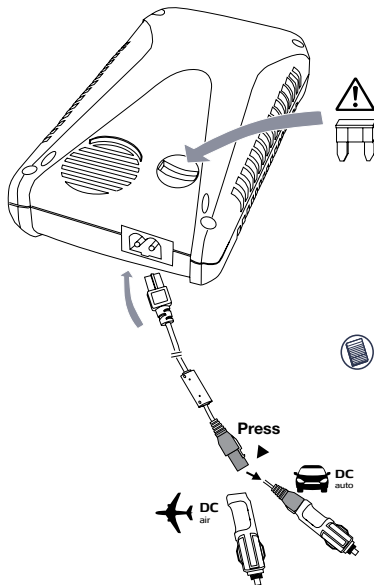

Fuse CAUTIONS

This inverter is fitted with a spade type 32Vdc 15A fuse. If the fuse blows, replace with a same specification and type fuse. Usage of another type fuse or metal wire will cause abnormal overheating or even fire hazards.



Note: When replacing the fuse, please make sure that all the electrical device(s) are turned off and the power cables are unplugged. Make sure the fuse is replaced correctly and before reconnecting the device(s).

Hypertronics to CLA auto/air adapter

DC In-Auto connector

DC In-Air connector (for airline compatibility, go to Web site below)

<http://www.targus.com/>

Typical Usage

This listing is for reference purposes only. Some devices exceed the wattages listed. Before using the device, please refer to the owner's manual for actual wattage required.

Cellular Phone Charger	25 Watt
Portable Color Printer	30 Watt
Blu-Ray DVD Player	30 Watt
Tablet	30 Watt
32 Inch LCD TV	70 Watt
Portable CD player	85 Watt
Gaming Console	90 Watt
Notebook computer	90 Watt
Work Light	100 Watt

Electrical Ratings:

Input: 12-16Vdc

AC Output: 120Vac 60 Hz
(modified sinewave)

100W continuous (150W surge)

USB Output: 5Vdc 500mA



WARNINGS Any electric appliance with the power consumption beyond 100W is not allowed for usage. This inverter is not recommended for use with inductive loads, such as fluorescent lamps or pumps and most heat generation equipment such as hair dryers, coffee makers, irons, heaters and toasters. Otherwise, permanent damage to the unit and excessive overheating may result.



WARNINGS If the external cable of this inverter is damaged, stop using this and contact the authorized agent to replace it in order to avoid hazard.



CAUTIONS Regularly check input and output connections are tight. Loose connections can generate harmful heat and / or damage the inverter or power source. Prevent shock hazard.

Trouble Shooting

Problem: No Power Output, indicator not ON

Possible causes and suggestions:

- **The car's battery is low (<11.5Vdc) or defective**
Start the engine to recharge or replace the car's battery if needed. Disconnect the input cable before starting the car's engine to minimize power surge. If such a case occurs, reconnect the cable to resume normal operation.
- **Connection cable is not secured**
Reconnect the cables and make sure all plugs are secured.
- **Equipment being operated draws too much power**
Reduce load to continuous 100 watts or below and use equipment with starting surge power within inverter capability.
- **Inverter in thermal shut down condition**
Allow the inverter to cool down. Ensure there is ventilation around the unit.

- **Inverter fuse blown**

Unplug the power cable and replace the fuse following fuse replacement instruction.

- **Automotive fuse for cigarette lighter blown**

Check and replace the fuse for your car's cigarette lighter following the instructions in your car's service manual.

Problem: Low Output Voltage

Possible cause and suggestions:

- **Inverter is overloaded**

Reduce load to continuous 100 watts or below to maintain regulation.

- **Input voltage below 11.5Vdc**

Keep input voltage above 12Vdc to maintain regulation.
Replace the car's battery if needed.



WARNINGS

Any electric appliance with the power consumption beyond 100W is not allowed for usage. This inverter is not recommended for use with inductive loads, such as fluorescent lamps or pumps and most heat generation equipment such as hair dryers, coffee makers, irons, heaters and toasters. Otherwise, permanent damage to the unit and excessive overheating may result.

Safety Precautions

- This device outputs 120 Volts of electricity just as a wall socket does. Exercise extreme care that nothing comes in contact with the AC connector.
- Do not use in the presence of water or moisture.
- Do not use or place the inverter near flammable materials or any locations that may accumulate flammable fumes or gases.
- To avoid potential property damage, do not leave this inverter or any device operating unattended in vehicle.
- Always disconnect the input to the inverter when it is not in use.
- Disconnect the input cable before starting your car to minimize surges.
- Reverse polarity connection will result in a blown fuse and may cause permanent damage to the inverter (Damage due to reversed polarity is not covered by our warranty).
- Do not connect to AC distribution wiring.
- Improper use of this inverter can cause personal injury, property damage, and or loss of life.
- This is not a toy. Keep away from reach of children.
- Indoor use only.



WARNINGS

If the external cable of this inverter is damaged, stop using this and contact the authorized agent to replace it in order to avoid hazard.



CAUTIONS

Regularly check input and output connections are tight. Loose connections can generate harmful heat and / or damage the inverter or power source. Prevent shock hazard.

Ventilation openings

- Do not block or cover any louvered vents. Place the inverter on a flat surface with good ventilation between 0-35 °C and ideally 15-25 °C.
- Do not place the inverter on or near a heating vent or any piece of heat generating equipment. Keep inverter away from direct sunlight, if at all possible.
- Do not allow water or other liquids to come into contact with the inverter.

Technical Support

For technical questions, please visit:

US	Internet: http://targus.com/us/support
Australia	Internet: http://www.targus.com/au/support Email: infoaust@targus.com Telephone: 1800-641-645
New Zealand	Telephone: 0800-633-222
Latin America	Email: soporte@targus.com

Product Registration

Targus recommends that you register your Targus accessory shortly after purchasing it.

Go to: http://targus.com/us/product_registration

You will need to provide your full name, email address, country of residence and product information.

One Year Warranty

We pride ourselves on the quality of our products. For complete warranty details and a list of our worldwide offices, please visit www.targus.com. Targus product warranty does not cover any device or product that is not manufactured by Targus (including, but not limited to, laptops, smartphones, devices, or any other product that may be used in connection with the Targus product). Australian customers: For complete warranty details see warranty statement enclosed.

Targus is a registered trademark of Targus International, LLC in the U.S. and in certain other countries. All logos and registered trademarks are the property of their respective owners. ©2019 Targus, 1211 North Miller Street, Anaheim, CA 92806. All rights reserved.

AUSTRALIAN AND NEW ZEALAND CONSUMERS ONLY

Thank you for your purchase. Targus warrants to the original purchaser that its products are free from defects in materials and workmanship, during the specified warranty period, and lasts as long as the original purchaser owns the product. The warranty period is stated on the packaging or in the documentation provided with this Targus product.

Targus' Limited Product Warranty excludes damage caused by accident, neglect, abuse, misuse, improper care, normal wear and tear, ownership transfer, or alteration. The limited warranty also excludes any product that is not manufactured by Targus (including, without limitation, laptops, smartphones, devices, tablets, or any other non-Targus item) that is used in connection with the Targus product.

In the event that the Targus product has a defect in materials or workmanship Targus will, after receiving a warranty claim and inspecting the product, at its discretion, do one of the following: repair, replace, or refund with the same or a similar product (or part) of no lesser quality and ship it to the original purchaser at Targus' expense. As part of this inspection, proof of purchase will be required. There is no charge for inspection. To make a warranty claim, please contact Targus Australia or New Zealand (see details below), or return the product to the place of purchase. The original purchaser must bear the cost of the delivery to Targus.

Under Australian and/or New Zealand Consumer Laws, in addition to any warranty Targus gives, our products come with guarantees that cannot be excluded. You are entitled to a replacement or refund for a major failure and compensation for any other reasonably foreseeable loss or damage. You are entitled to have the products repaired or replaced if they fail to be of acceptable quality and the failure does not amount to a major failure.

For any warranty question, contact Targus Australia Pty. Ltd. (i) by mail at Suite 2, Level 8, 5 Rider Boulevard, Rhodes NSW 2138, by phone AUS 1800 641 645 or NZ 0800 633 222 or by Email: infoaust@targus.com. For additional information, check out our website at targus.com/au/warranty.

Regulatory Compliance

This device complies with Part 15 of the FCC Rules. Operation is subject to the following two conditions: (1) This device may not cause harmful interference, and (2) This device must accept any interference received, including interference that may cause undesired operation.

FCC Statement Tested to Comply

This device complies with Part 15 of the FCC Rules. Operation is subject to the following two conditions:

1. This device may not cause harmful interference, and
2. This device must accept any interference received, including interference that may cause undesired operation.

Warning: Changes or modifications not expressly approved by the party responsible for compliance could void the user's authority to operate the equipment.

NOTE: This equipment has been tested and found to comply with the limits for a Class B digital device, pursuant to Part 15 of the FCC Rules. These limits are designed to provide reasonable protection against harmful interference in a residential installation.

This equipment generates, uses, and can radiate radio frequency energy and, if not installed and used in accordance with the instructions, may cause harmful interference to radio communications. However, there is no guarantee that interference will not occur in a particular installation. If this equipment does cause harmful interference to radio or television reception, which can be determined by turning the equipment off and on, the user is encouraged to try to correct the interference by one or more of the following measures:

- Reorient or relocate the receiving antenna.
- Increase the separation between the equipment and receiver.
- Connect the equipment into an outlet on a circuit different from that to which the receiver is connected.
- Consult the dealer or an experienced radio/TV technician for help.

Declaration of Conformity

Hereby, Targus declares that this device is in compliance with the essential requirements and other relevant provisions of Directive 2014/30/EU.



Supplier's Declaration of Conformity

Per FCC Part 2 Section 2.1077(a)



Manufacturer/ Responsible Party :	Targus International LLC	Tel:	1-714-765-5555
Address :	1211 North Miller Street Anaheim, CA 92806 USA	Fax:	1-714-765-5599
		Internet:	www.targus.com

Hereby declares that the Product

Trade name: Targus

Product name: Power Inverter

Model number: APV10US1

Conforms to the following specifications

FCC CFR Title 47 Part 15 Subpart B and ANSI C63.4-2014 standard limits
The test data & results are referred to the test report Number:
(SZEM1812001062AT)

Supplementary Information:

This device complies with part 15 of the FCC Rules. Operation is subject to the following two conditions: (1) This device may not cause harmful interference, and (2) this device must accept any interference received, including interference that may cause undesired operation.

Director, Quality & Compliance,
/Targus International LLC
Function Title

Jan 08, 2019

Date

CF Ngoh

Name

Signed for and on behalf of Targus

1 YEAR LIMITED WARRANTY: We pride ourselves on the quality of our products. For complete warranty details and a list of our worldwide offices, please visit www.targus.com. Targus product warranty does not cover any device or product that is not manufactured by Targus (including, but not limited to, laptops, smartphones, devices, or any other product that may be used in connection with the Targus product).

Targus is a registered trademark of Targus International, LLC in the U.S. and in certain other countries. All logos and registered trademarks are the property of their respective owners. ©2019 Targus, 1211 North Miller Street, Anaheim, CA 92806. All rights reserved.

